





## Clamp Ferrules

### Short Welding Ferrules - 14WMP

Tube OD	Dimensions			304	316L
	A	B	C	Part Number	Part Number
1/2"	.500	.370	.500	14WMP-G50	14WMP-R50
3/4"	.500	.620	.750	14WMP-G75	14WMP-R75
1"	.500	.870	1.000	14WMP-G100	14WMP-R100
1 1/2"	.500	1.370	1.500	14WMP-G150	14WMP-R150
2"	.500	1.870	2.000	14WMP-G200	14WMP-R200
2 1/2"	.500	2.370	2.500	14WMP-G250	14WMP-R250
3"	.500	2.870	3.000	14WMP-G300	14WMP-R300
4"	.625	3.834	4.000	14WMP-G400	14WMP-R400
5"	.750	4.782	5.000	14WMP-G500 	14WMP-R500 
6"	.875	5.782	6.000	14WMP-G600	14WMP-R600
8"	.875	7.760	8.000	14WMP-G800	14WMP-R800
10"	.875	9.782	10.000	14WMP-G1000	14WMP-R1000
12"	.875	11.760	12.000	14WMP-G1200	14WMP-R1200

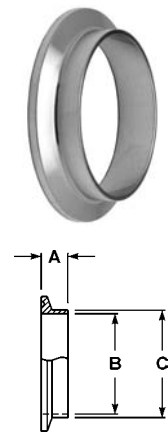

### Buttweld Ferrules - L14AM7

Tube OD	Dimensions			304	316L
	A	B	C	Part Number	Part Number
1/2"	1.125	.370	.500	L14AM7-G50	L14AM7-R50
3/4"	1.125	.620	.750	L14AM7-G75	L14AM7-R75
1"	1.125	.870	1.000	L14AM7-G100	L14AM7-R100
1 1/2"	1.125	1.370	1.500	L14AM7-G150	L14AM7-R150
2"	1.125	1.870	2.000	L14AM7-G200	L14AM7-R200
2 1/2"	1.125	2.370	2.500	L14AM7-G250	L14AM7-R250
3"	1.125	2.870	3.000	L14AM7-G300	L14AM7-R300
4"	1.125	3.834	4.000	L14AM7-G400	L14AM7-R400
5"	1.125	4.782	5.000	L14AM7-G500 	L14AM7-R500 
6"	1.500	5.782	6.000	L14AM7-G600	L14AM7-R600
8"	1.500	7.760	8.000	L14AM7-G800	L14AM7-R800
10"	1.750	9.782	10.000	L14AM7-G1000	L14AM7-R1000
12"	1.750	11.760	12.000	L14AM7-G1200	L14AM7-R1200

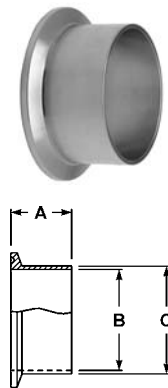

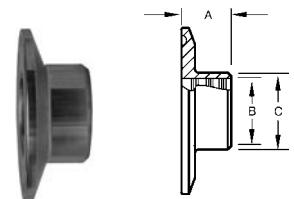

### Reducing Roll-on Ferrules \* - B31RMP

Clamp End x Tube OD	Dimensions			304
	A	B	C	Part Number
1 1/2" x 1"	.750	1.007	1.160	B31RMP-G150100
2" x 1"	.750	1.007	1.160	B31RMP-G200100
2" x 1 1/2"	1.125	1.507	1.676	B31RMP-G200150



\* for use when modifying or repairing existing on-site farm milk handling systems

### Reducing Ferrules - B31WMP

Size	Dimensions			304	316L
	A	B	C	Part Number	Part Number
2" x 1"	.500	.870	1.000	B31WMP-G200100	B31WMP-R200100
2 1/2" x 1 1/2"	.500	1.370	1.500	B31WMP-G250150	B31WMP-R250150
2 1/2" x 2"	.500	1.870	2.000	B31WMP-G250200	B31WMP-R250200
3" x 2"	.500	1.870	2.000	B31WMP-G300200	B31WMP-R300200
3" x 2 1/2"	.500	2.370	2.500	B31WMP-G300250 	B31WMP-R300250 
4" x 3"	.625	2.870	3.000	B31WMP-G400300	B31WMP-R400300

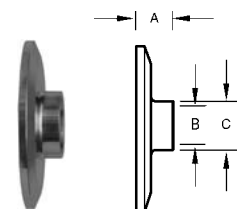

**B**

## Clamp Ferrules

### Roll-On Expanding Ferrules \* - 14RMP

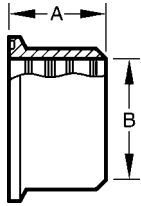

Tube OD	Dimensions		304	316L
	A	B	Part Number	Part Number
1"	.750	1.005	14RMP-G100	14RMP-R100
1½"	1.125	1.505	14RMP-G150	14RMP-R150
2"	1.312	2.005	14RMP-G200	14RMP-R200
2½"	1.375	2.505	14RMP-G250	14RMP-R250
3"	1.437	3.005	14RMP-G300	14RMP-R300
4"	1.500	4.005	14RMP-G400	14RMP-R400
6"	2.000	6.005	14RMP-G600	---

\* for use when modifying or repairing existing on-site farm milk handling systems

### 316L Automatic Welding Ferrules - TL14AM7

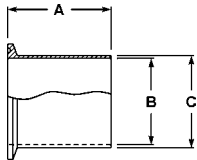

Tube OD	Dimensions			Part Number
	A	B	C	
½"	1.750	.370	.500	TL14AM7-R50
¾"	1.750	.620	.750	TL14AM7-R75
1"	1.750	.870	1.000	TL14AM7-R100
1½"	1.750	1.370	1.500	TL14AM7-R150
2"	2.250	1.870	2.000	TL14AM7-R200
2½"	2.250	2.370	2.500	TL14AM7-R250
3"	2.250	2.870	3.000	TL14AM7-R300
4"	2.250	3.834	4.000	TL14AM7-R400

• meets ASME BPE-2002 specifications

### Light Tank Ferrules - 14WLMP

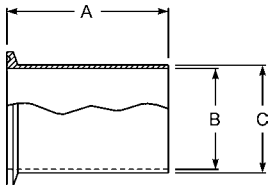

Tube OD	Dimensions			304	316L
	A	B	C	Part Number	Part Number
1"	3.000	.870	1.000	14WLMP-G100	14WLMP-R100
1½"	3.000	1.370	1.500	14WLMP-G150	14WLMP-R150
2"	3.000	1.870	2.000	14WLMP-G200	14WLMP-R200
2½"	3.000	2.370	2.500	14WLMP-G250	14WLMP-R250
3"	4.000	2.870	3.000	14WLMP-G300	14WLMP-R300
4"	4.000	3.834	4.000	14WLMP-G400	14WLMP-R400
6"	6.000	5.782	6.000	14WLMP-G600	14WLMP-R600
8"	6.000	7.760	8.000	14WLMP-G800	14WLMP-R800
10"	6.000	9.782	10.000	 14WLMP-G1000	14WLMP-R1000
12"	6.000	11.760	12.000	14WLMP-G1200	14WLMP-R1200

## Clamp Ferrules

### 316L Heavy Wall Ferrules - 14MPW

Tube OD	Dimensions			Part Number
	A	B	C	
1/2"	1.625	.321	.502	14MPW-R50
3/4"	1.625	.574	.750	14MPW-R75
1"	1.625	.870	1.160	14MPW-R100
1 1/2"	1.625	1.370	1.676	14MPW-R150
2"	1.750	1.870	2.192	14MPW-R200
2 1/2"	1.750	2.370	2.708	14MPW-R250
3"	1.813	2.870	3.224	14MPW-R300
4"	2.125	3.834	4.256	14MPW-R400
6"	2.500	5.758	6.192	14MPW-R600
8"	2.500	7.758	8.192	14MPW-R800

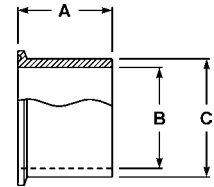

- 1/2" - 4" certified to ASME SA479
- 6" - 8" certified to ASME SA312

## Clamp Adapters

### Clamp x Plain Bevel Seat Adapters with Hex Nut - 17MP-14

Tube OD	Dimension A	304
		Part Number
1"	3.000	17MP-14-G100
1 1/2"	3.000	17MP-14-G150
2"	3.000	17MP-14-G200
2 1/2"	3.500	17MP-14-G250
3"	3.750	17MP-14-G300
4"	4.000	17MP-14-G400

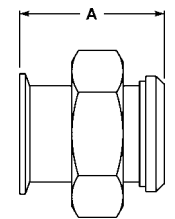

- hex nut is CF8 (304) stainless

### Clamp x Threaded Bevel Seat Adapters - 17MP-15

Size	Dimension A	304
		Part Number
1"	1.688	17MP-15-G100
1 1/2"	1.719	17MP-15-G150
2"	1.719	17MP-15-G200
2 1/2"	1.844	17MP-15-G250
3"	1.906	17MP-15-G300
4"	2.344	17MP-15-G400

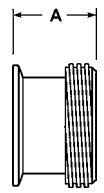
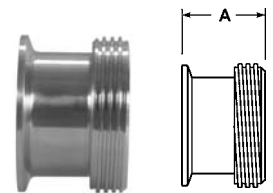

## 316L Tygon® Hose Adapters - 14MPHT

Tube OD	Dimensions			Part Number
	A	B	C	
1/2"	4.000	.370	.500	14MPHT-R50
3/4"	4.000	.620	.750	14MPHT-R75
1"	4.500	.870	1.000	14MPHT-R100
1 1/2"	4.500	1.370	1.500	14MPHT-R150
2"	4.500	1.870	2.000	14MPHT-R200
2 1/2"	4.500	2.370	2.500	14MPHT-R250
3"	4.500	2.870	3.000	14MPHT-R300
4"	4.625	3.834	4.000	14MPHT-R400
6"	6.000	5.782	6.000	14MPHT-R600

